



## Lifting Equipments



YM-2000

### FEATURES

- Highly nominal and efficient roller bearing is used on the gear.
- The gear has received heat treatment high precision processing and is abrasion resistant.
- The power is under even distribution of force for higher safety and longer lifetime.
- The electromagnetic brake requires no adjustment clearance and it brakes automatically during power failure thereby offering both safety and reliability.
- Motor sensor for longer and more frequent usage as well as easy maintenance.
- Three phases 220V/380V/440V.

### SPECIFICATION

- Lifting Capacity (top layer) : 2,000 kg
- Lifting Speed : Option : 15 ~ 20 m/min
- Motor : Option : 7.5 HP x 4 poles
- Lifting height : 97 m
- Wire Rope : 14 mm x 100 m

Note :

Above performance ratings are based on 50 Hz supply. (60 Hz motor available as option resulting in a reduction of lifting capacities by 20% and a speed increase of 20%)

1. All ratings are based on the top layer. For each layer reduction on the drum pulling capacity is increased by 10%
2. Use a snatch block for double line operation, to increase line pull by approximately 85%

### DIMENSIONS (mm)

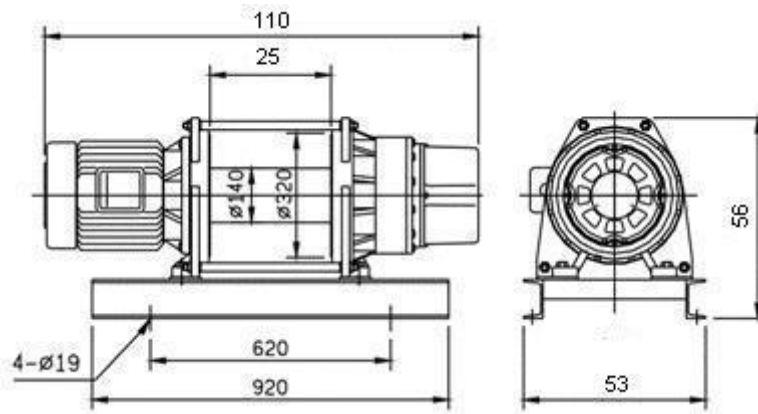

#### STANDARD ACCESSORIES

- Wire rope w/safety hook
- Switch cord 1.25 mm x 3C x 3 m
- Power lead 3.5 mmx 4C x 0.3 m
- Pendant Switch K61
- Base Plate

#### OPTIONAL ACCESSORIES

- Pendant control K-61B assembly

#### PACKAGE

- Winch Weight : 300 kg
- Gross Weight : 301 kg

### Industrial Electrical Winch



#### Features

- Lightweight and compact design allows easy installation
- Automatic upper limit switch when rope disc touches the limit arm, hoisting is automatically stopped
- Dynamic and mechanical brake provides instant and safe braking
- can operate on standard domestic power supply
- Sensor arm automatically stops motor if the wire rope is under-wound
- Wire rope comes with a 360° weight hook with safety latch

#### Standard Accessories

- Wire rope 5mmx70m
- Weight hook K-11
- Switch cord 2mm<sup>2</sup>x5Cx7m
- Power lead 2mm<sup>2</sup>x3Cx4.5m
- Pendant switch K-160

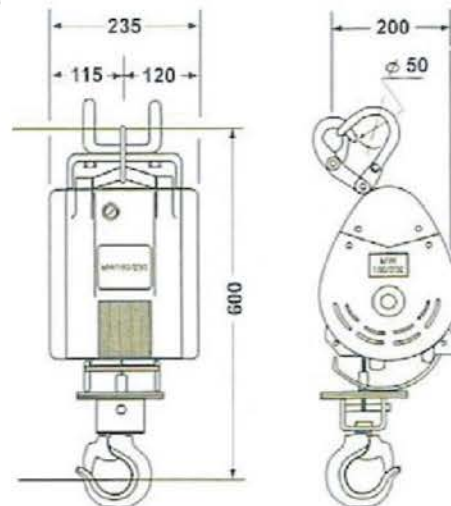

Model		YM-230	YM-360	YM-500
Lifting Capacity kg Wire Rope Top Layer		230	360	500
Lifting Speed m/min	First Layer	9	13	8
	Top Layer	14	18	12
Motor kw x A	220V-240V	1.3x6.5	1.8x7	2.0x7
Lifting Height m		29	59	29
Wire rope Ø mm x m		5x30	5x60	6.35x30
Net Weight kg		18	23	28
Gross Weight kg		25	30	35

### Industrial Electrical Winch

#### Features

- Lightweight and compact design for easy installation
- Dynamic and mechanical brake provides instant and safe braking
- Operates on standard household power supply
- Comes complete with wire rope and hook
- Enclosed drum flange to prevent ropes becoming trapped between drum and support castings

#### Standard Accessories

- Wire rope 5mmx70m
- Switch cord 2mm<sup>2</sup>x6Cx6m
- Switch cord 2mm<sup>2</sup>x3Cx4.5m
- Pendant switch K-613

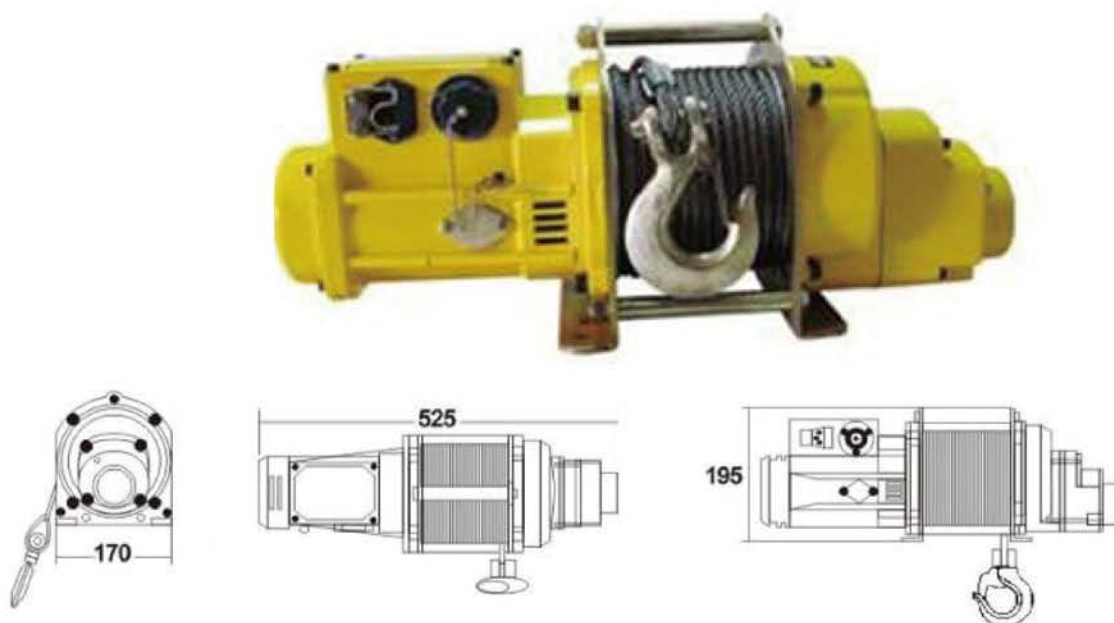

Model			YM-301L	YM-501S
Lifting Capacity kg Wire Rope Top Layer			300	500
Lifting Speed m/min	First Layer		12	7
	Top Layer		16	11
Motor kw X A	Type		Series Wound	Series Wound
	Output	220V-240V	14x6.5	14x6.5
Braking Methods	For Motor		Electromagnetic Brake	Electromagnetic Brake
	For Gear		Mechanical Brake	Mechanical Brake
Lifting Height m			69	24
Wire Rope	Diameter mm		5	7
	Length m		70	25
	Construction		6x19	6x19
Drum Dimension mm	Width		115	115
	Drum Dia		80	80
	Flange Dia		123	123
Mounting Bolt pattern mm			153x80	153x80
			167x132	167x132
Net Weight kg			27	28
Gross Weight kg			29	30

### Heavy-Duty Industrial Electrical Winch

#### Features

- Positive retention of wire rope on to drum
- Electromagnetic spring-applied fail safe brake
- Heavy duty high efficiency ball bearings on all running surfaces
- planetary gearing for maximum mechanical efficiency
- Enclosed drum flange to prevent ropes becoming trapped between drum and support castings quiet running

#### Standard Accessories

- Wire rope 8mmx50m for YM-501
- Weight hook K-17
- Switch cord 3.55mm<sup>2</sup>x5Cx3m
- Power lead 5.5mm<sup>2</sup>x3Cx60com and industry plug
- Pendant switch K-213

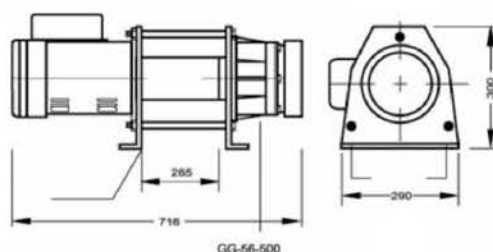

Model		YM-501
Lifting Capacity kg Wire Rope Top Layer		500
Lifting Speed m/min	First Layer	18
	Top Layer	23
Motor Rating IP44	kw/poles	1.8 x 4
Maximum Lifting Height m		49
Wire Rope ø mm x m		8 x 50
Drum Dimension	Width	210
	Drum Dia	92
	Flange Dia	200
Mounting Bolt Pattern mm		255 x 165
Net Weight kg		62
Gross Weight kg		65



### Heavy-Duty Industrial Electrical Winch

#### Features

- Heavy duty high efficiency ball bearings on all running surfaces
- Planetary gearing for maximum efficiency
- Cast steel foot mounting
- Fabricated steel drum
- Electromagnetic spring-applied fail safe brake
- Supplied on steel base plate ready to mount
- Enclosed drum flange to prevent ropes becoming trapped between drum and support castings quietrunning

#### Standard Accessories

- Wire rope w/ safety hook
- Switch cord 1.25mm<sup>2</sup>3Cx10m
- Power lead 14mm<sup>2</sup>x4Cx1m
- Pendant switch K-61
- Base Plate

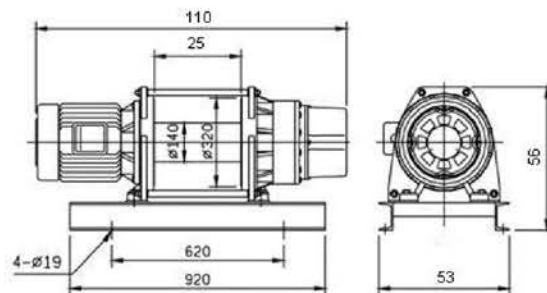

Model	YM-1000
Lifting Capacity (Top Layer kg)	1000
Lifting Speed (m/min)	15-20
Motor (kw x poles)	5.5x4
Lifting (Height m)	58
Wire Rope (ø mm x m)	10x60
Net Weight (kg)	210
Gross Weight (kg)	240

### PA100A

#### Features

Emergency stop switch  
Upper limit device  
Thermal protection terminal  
Protection class IP54



Method of use	Single hook	Double hook
Rated volt(V)	220/230	
Input power(W)	180	
Rated lifting weight(kg)	50	100
Lifting speed(m/min)	10	5
Lifting height(m)	8	4
Qty/CTN(PCS)	4	
packing dimension(cm)	41x30x22	
G.W./N.W.(kg)	21/20	

### PA200A

#### Features

Emergency stop switch  
Upper limit device  
Thermal protection terminal  
Protection class IP54



Method of use	Single hook	Double hook
Rated volt(V)	220/230	
Input power(W)	450	
Rated lifting weight(kg)	100	200
Lifting speed(m/min)	10	5
Lifting height(m)	12	6
Qty/CTN(PCS)	2	
packing dimension(cm)	46x36x16	
G.W./N.W.(kg)	21/20	

### PA250A

#### Features

Emergency stop switch  
Upper limit device  
Thermal protection terminal  
Protection class IP54



Method of use	Single hook	Double hook
Rated volt(V)	220/230	
Input power(W)	500	
Rated lifting weight(kg)	125	250
Lifting speed(m/min)	10	5
Lifting height(m)	12	6
Qty/CTN(PCS)	2	
packing dimension(cm)	46x36x16	
G.W./N.W.(kg)	21/20	

## PA300A

### Features

Emergency stop switch  
Upper limit device  
Thermal protection terminal  
Protection class IP54



Method of use	Single hook	Double hook
Rated volt(V)	220/230	
Input power(W)	550	
Rated lifting weight(kg)	150	300
Lifting speed(m/min)	10	5
Lifting height(m)	12	6
Qty/CTN(PCS)	2	
packing dimension(cm)	46x36x16	
G.W./N.W.(kg)	22/21	

## PA400A

### Features

Emergency stop switch  
Upper limit device  
Thermal protection terminal  
Protection class IP54



Method of use	Single hook	Double hook
Rated volt(V)	220/230	
Input power(W)	750	
Rated lifting weight(kg)	200	400
Lifting speed(m/min)	10	5
Lifting height(m)	12	6
Qty/CTN(PCS)	2	
packing dimension(cm)	52x41x17	
G.W./N.W.(kg)	33/31	

## PA500A

### Features

Emergency stop switch  
Upper limit device  
Thermal protection terminal  
Protection class IP54



Method of use	Single hook	Double hook
Rated volt(V)	220/230	
Input power(W)	900	
Rated lifting weight(kg)	250	500
Lifting speed(m/min)	10	5
Lifting height(m)	12	6
Qty/CTN(PCS)	2	
packing dimension(cm)	52x41x17	
G.W./N.W.(kg)	34/32	

## PA600A

### Features

Emergency stop switch  
Upper limit device  
Thermal protection terminal  
Protection class IP54



Method of use	Single hook	Double hook
Rated volt(V)	220/230	
Input power(W)	1050	
Rated lifting weight(kg)	300	600
Lifting speed(m/min)	10	5
Lifting height(m)	12	6
Qty/CTN(PCS)	2	
packing dimension(cm)	52x41x17	
G.W./N.W.(kg)	36/34	



# YAMA

## Electric Windlass Series



KDJ-200E、KDJ-250E、  
KDJ-300E、KDJ-300E1、



KDJ-500E1、KDJ-750E1、  
KDJ-1000E1、KDJ-10000E1、

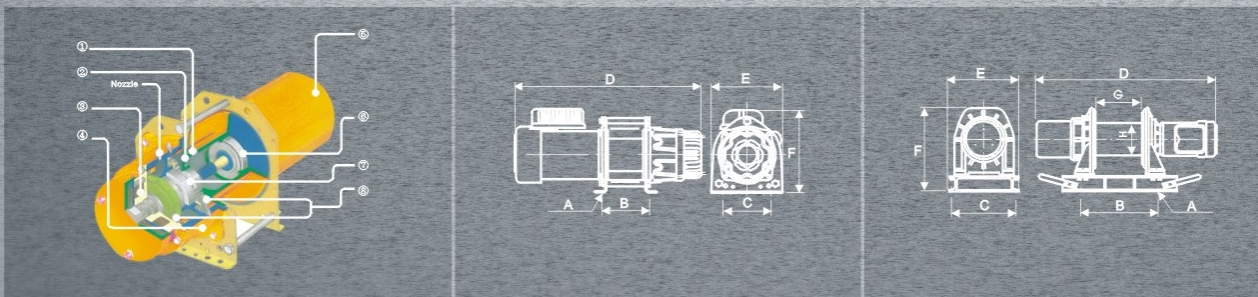

### 技术参数 TECHNIQUE PARAMETER

型号 Model	额定 载荷 Rated Load (kg)	额定 速度 Rated Speed (m/min)	提升 高度 Lifting Height (m)	钢丝绳 直径 Cable Diameter (mm)	容绳 量 Cord Capacity (m)	工作 级别 Work Level	电 机 Motor (kw)	电 压 Volt(v)	频 率 Frequency (Hz)	净 重 N.W. (Kg)
KDJ-200E	200	11	29	ø6	30	M3	0.6×4	AC 100/110/ 120/220/ 230/240	50/60	36
KDJ-250E	250						0.75×4			40
KDJ-300E	300						1.1×4			49
KDJ-300E <sub>1</sub>		Three phase		48						
KDJ-500E <sub>1</sub>	500	13	58	ø9	60		2.2×4	230/ 380/ 415/ 440/ 480		136
KDJ-750E <sub>1</sub>	750						3×4			149
KDJ-1000E <sub>1</sub>	1000						4×4			156

### 外形尺寸 DIMENSIONS IN MM

符号 Symbol	A	B	C	D	E	F	G	H
型号 Model								
KDJ-200E	4-ø105	142	142	510	210	246	108	ø94
KDJ-250E				525				
KDJ-300E				540				
KDJ-300E1	4-ø14	172	172	548	372	430	240	ø140
KDJ-500E1				548				
KDJ-750E1				548				
KDJ-1000E1	4-ø18	400	330	935	372	430	240	ø140



**H-2500**

**2,500 kg**

**Cable Puller**

110V, 220V-240V x 1ph AC



- Dual pulling capacities of 2,500 kg and 1,500 kg
- Dual speeds vary according to drum size
- A overload protection switch ensure automatic shut-off
- Electromagnetic spring-apply failsafe brake
- Heavy duty high efficiency ball bearings on all running surfaces
- Rugged high power induction motor of proven reliability
- Case hardened gear train for maximum mechanical efficiency
- Suitable for continuous pulling to tackle the toughest wall, ground and underground pulling applications

#### SPECIFICATIONS

MODEL		Large drum	Small drum
Pulling capacity kg		1,500	2,500
Rope speed m/mm	50 Hz	4.0	2.5
	60 Hz	5.0	3.0
Gear train		hypoid gear plus spur gears	
Gear ratio		154:1	
Motor rating IP44		600 w	
Drum dimension, mm	length	124	104
	drum dia.	110	74
	flange dia.	166	94
Cable puller weight, kg		60	
Gross weight, kg		83	
Body dimension, mm (L x D x H)		457 x 362 x 267	
Box dimension, mm (L x D x H)		610 x 720 x 500	

#### STANDARD ACCESSORIES

- Rope arm
- Base plate
- Wire rope 8 mm x 50 m
- Detachable rope storage roller
- Foot control with 2.0 mm<sup>2</sup> x 3C x 2 m lead
- Power lead coming with 1.5 mm<sup>2</sup> x 3C x 3 m

#### DIMENSION mm/in

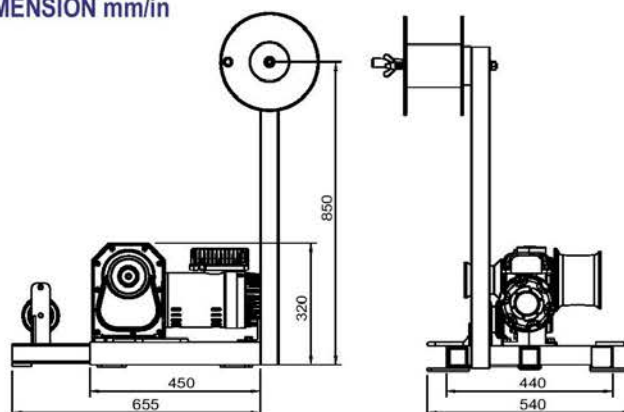



# ELECTRIC Winch (Longer rope)

# YAMA

300kg

< 110V or 220V-240V×1ph AC >

## FEATURES:

- Positive retention of wire rope on to drum
- Electromagnetic spring-applied fail safe brake
- Heavy duty high efficiency ball bearings on all running surfaces
- Planetary gearing for maximum mechanical efficiency
- Enclosed drum flange to prevents ropes becoming trapped between drum and support castings quietrunning

## WARNING:

Winches are not to be used for the moving of persons

## WARRANTY:

Each new winch is guaranteed against defects in workmanship and material defects for a period of twelve months from date of purchase.

Wire ropes are not included under warranty.

## STANDARD ACCESSORIES:

Wire rope 7mm×30m

Weight hook K-15

Switch cord 2mm<sup>2</sup>×5C×3m

Power lead 3.5mm<sup>2</sup>×3C×60com and industry plug

Pendant switch K-213

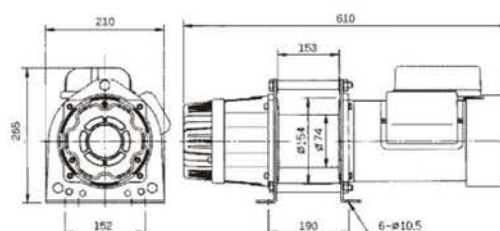

## OPTIN ACCESSORIES:

Remote control K-213A assembly

## SPECIFICATIONS

Model		YM-301E
Lifting capacity kg wire rope top layer		300
Lifting speed m/min	first layer	12
	top layer	18
Motor rating IP44	kw/poles	1.15 × 4
Maximum lifting height m		44
Wire rope φ mm × m		6 × 45
	width	153
Drum dimension mm	drum dia	74
	flange dia	154
Net weight kg		36
Gross weight kg		38

# ELECTRIC Winch

# YAMA

500. 500kg

< 220V-240V×1ph AC  
220V-380V-440V×3ph AC >



## FEATURES:

- Positive retention of wire rope on to drum
- Electromagnetic spring-applied fail safe brake
- Heavy duty high efficiency ball bearings on all running surfaces
- Planetary gearing for maximum mechanical efficiency
- Enclosed drum flange to prevents ropes becoming trapped between drum and support castings quietrunning

## WARNING:

Winches are not to be used for the moving of persons

## WARRANTY:

Each new winch is guaranteed against defects in workmanship and material defects for a period of twelve months from date of purchase.

Wire ropes are not included under warranty.

## STANDARD ACCESSORIES:

Wire rope 8mm×30m for GG-500  
Wire rope 8mm×50m for GG-500L  
Weight hook K-17  
Switch cord 3.5mm<sup>2</sup>×5C×3m  
Power lead 5.5mm<sup>2</sup>×3C×60com and industry plug  
Pendant switch K-213

## OPTIN ACCESSORIES:

Remote control K-213A assembly

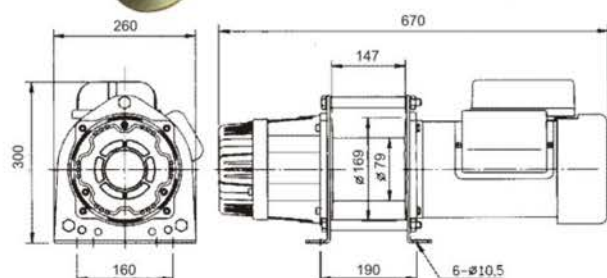

GG-500

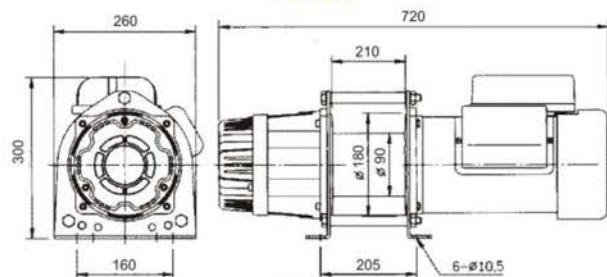

GG-500L

## SPECIFICATIONS

Model		YM-501E
Lifting capacity kg wire rope top layer		500
Lifting speed m/min	first layer	18
	top layer	23
Motor rating IP44	kw/poles	1.8×4
Maximum lifting height m		39
Wire rope φ mm × m		7 × 40
Drum dimension mm	width	210
	drum dia	79
	flange dia	169
Mounting bolt pattern mm		255×165
Net weight kg		62
Gross weight kg		65

# ELECTRIC Winch

# YAMA

< 220V-380V-440V×3ph AC >

1000. 2000. 3000kg

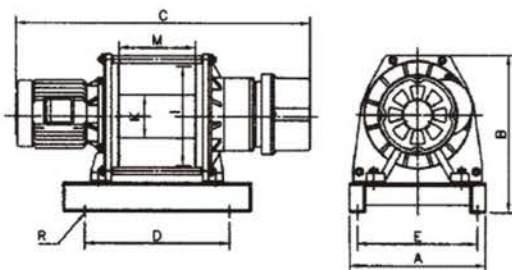

## FEATURES:

- Heavy duty high efficiency ball bearings on all running surfaces
- Planetary gearing for maximum efficiency
- Cast steel foot mounting
- Fabricated steel drum
- Electromagnetic spring-applied fail safe brake
- Supplied on steel base plate ready to mount
- Enclosed drum flange to prevents ropes becoming trapped between drum and support castings quietrunning

## WARNING:

Winches are not to be used for the moving of persons

## WARRANTY:

Each new winch is guaranteed against defects in workmanship and material defects for a period of twelve months from date of purchase.

Wire ropes are not included under warranty.

## STANDARD ACCESSORIES:

Wire rope w/safety hook  
Switch cord 1.25mm<sup>2</sup>×3C×10m  
Power lead 14mm<sup>2</sup>×4C×1m  
Pendant switch K-61  
Base plate

## OPTIN ACCESSORIES:

Remote control K-82A assembly

## DIMENSIONS MM

Model	Mounting bolt pattern			D	E	I	M	K	R
	A	B	C						
GG-1060	340	430	1000	400	336	280	240	110	4-φ16

## SPECIFICATIONS

Model	Lifting capacity top layer kg	Lifting speed m/min	Motor hp×poles	Lifting height m	Wire rope φ mm×m	Net weight kg	Gross weight kg
YM-1000E	1000	11-17	3×6	49	10×50	160	185